

SPECIFICATION DATA SHEET

PRODUCT DETAILS

Manufacturer :	ESSCO	Type:	EWC P-Trap
Colour:	White	Outlet	Horizontal
Technical Details:	Internal diameter of inlet hole dia. $\varnothing 50 \pm 3$ mm	Material:	Ceramic - Vitreous China
	External diameter of outlet hole dia. $\varnothing 100 \pm 5$ mm		
Vertical distance between the Floor and the centre line of the inlet hole ≤ 350 mm			

PRODUCT IMAGE



TECHNICAL DRAWING

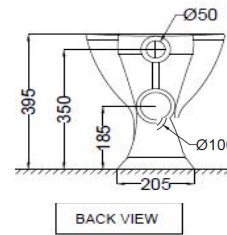
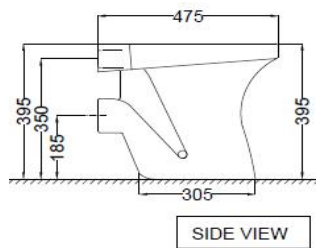
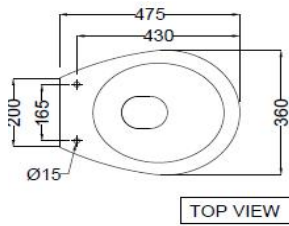

Product Dimension	360x475x395 mm	FEATURES
Product Weight	12.0 Kg	Packed with Accessories, Slim seat cover, Anti germ glaze, Trap glaze, Trap glaze, Dual Flushing - 3/6 LPF.

ACCESSORIES INCLUDED

PP Normal Close Seat cover	ECS-WHT-109N
Floor fixing screw	ZPS-SNS-FB01

ACCESSORIES EXCLUDED

Wall Hung Cistern	WHE-WHT-183L
-------------------	--------------

CERTIFICATION

All technical dimensions are in accordance to Bureau of Indian Standards

DISCLAIMER: Our every effort has been made to ensure factual accuracy, the information presented subject to changes due to requirements in different sites, markets and/or countries. All dimensions are in mm (Tolerance ± 5 MM). Jaquar reserves the right to make the necessary amendments at any time without prior notice.